

OXYGEN DROPPER POST DPR-E + DPR-S-E

SUPPLEMENTARY OPERATING INSTRUCTIONS

The present instructions refer exclusively to the dropper post and supplement the STEVENS operating instructions/manual. Therefore, read and observe both operating instructions/manual. These operating instructions are not intended to assemble, disassemble or basically maintain a dropper post, but provide some tips for use, adjustment and care. Read the present instructions and keep them for questions which may arise later. When you lend or sell the bicycle, pass on the instructions.

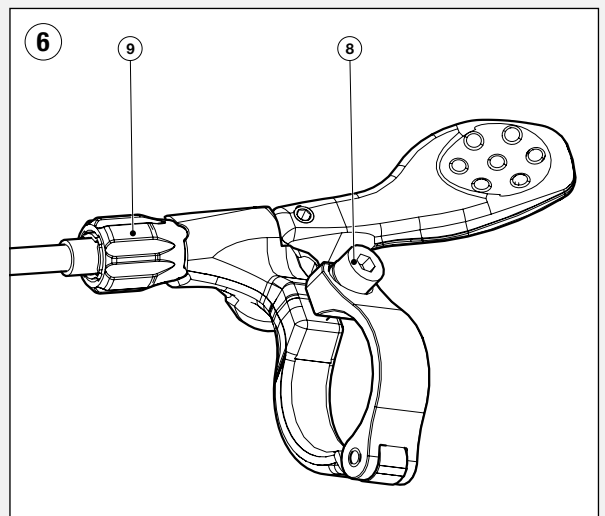
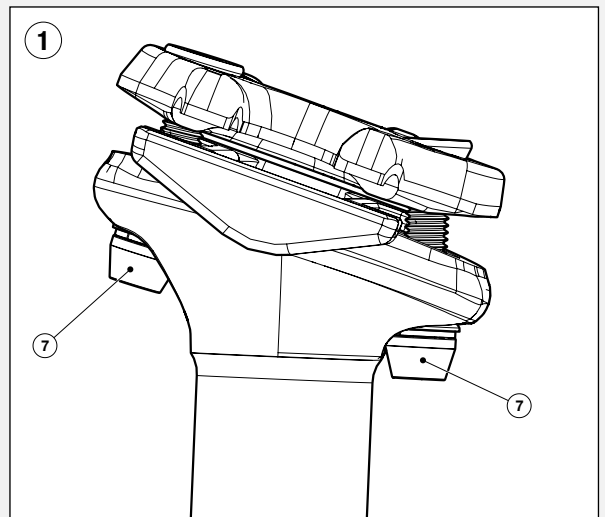
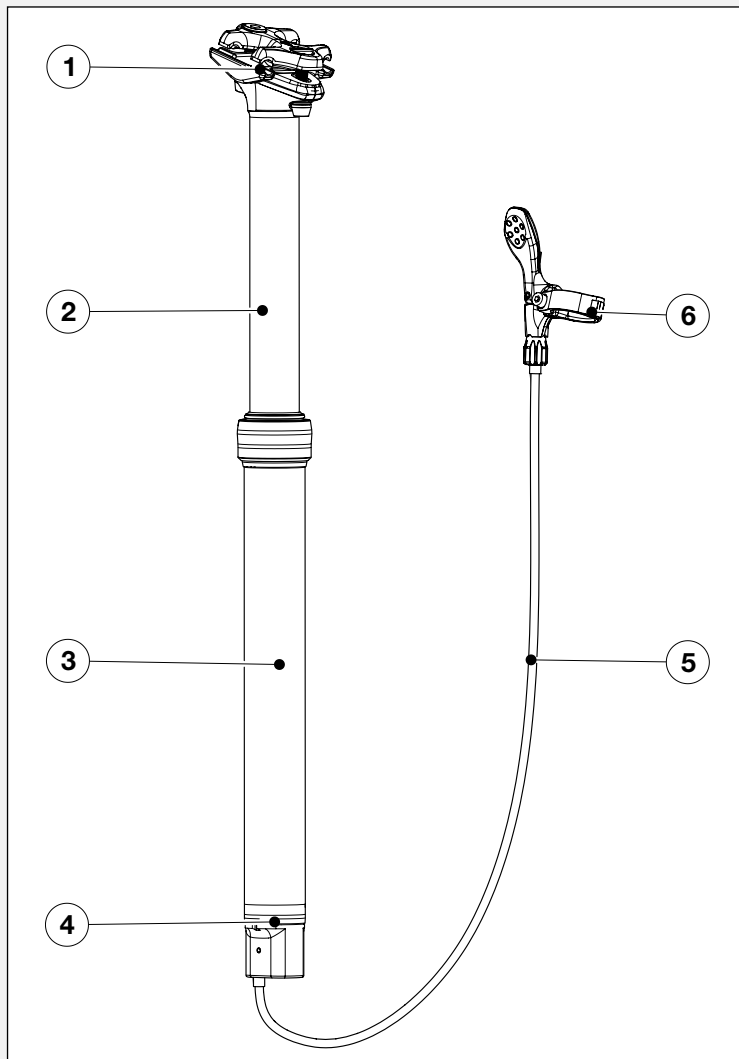

Specifications

Product Codes	Diameter	Upper Tube Length (2)	Full Length
23-4609	30.9 mm	100 mm	340 mm
23-4608		125 mm	390 mm
23-4709		150 mm	440 mm
23-4714		170 mm	480 mm
22-4749*		75 mm	360 mm
22-4750*		100 mm	410 mm

Minimum Seat Post Insertion	100 mm
Saddle Rail Compatibility	7x7 mm und 7x9 mm
Cable Compatibility	4 mm shifter housing/cable

Shared categories: to category 7 (E) (Freeride). Not approved for downhill, dirt and other aggressive riding styles.

***Shared categories:** to category 4 (E)-Plus. Not approved for downhill, dirt and other aggressive riding styles.

Components

- | | |
|-----------------------------|--------------------------|
| 1 Saddle clamp | 6 Control lever |
| 2 Upper stanchion | 7 M6 bolt, 8 - 10 Nm |
| 3 Lower tube | 8 M4 bolt, 1.2 to 1.6 Nm |
| 4 Release mechanism | 9 Tension adjuster |
| 5 Bowden cable with housing | |

Tools required

- Safety glasses, work gloves
- Hex key: 1.5 mm, 3 mm, 5 mm
- Torque wrench with bits

How to use the seat post

The Oxygen Dropper Post allows you to adjust the saddle height variably during the ride.

Varying saddle heights are helpful during the ride (higher saddle) as well as when getting on and off (lower saddle). Lower the saddle in time when riding downhill in the terrain. This gives you more free movement and thus better control of your bike.

When pressing the lever on the handlebar and removing the weight from the saddle, the seat post raises and it stops when you place your weight again on the saddle. By releasing the lever the saddle is fixed in this position.

When you sit on the saddle and press the lever the seat post drops due to your weight until you release the lever.

Intended use: The use of this product is limited to the terrain or the field of use described by means of the category of your STEVENS bike. You find more information on the intended use of your bike model and the STEVENS categories at www.stevensbikes.de

Do not overestimate your riding skills. Many tricks of professionals may look easy, but they require an above average fitness as well as many years of intensive training.

WARNING

Non-observance of these operating instructions and using the component outside the intended range of use may result in an accident with hardly foreseeable consequences and even death.

Notes on adjustment and care

SAFETY INSTRUCTIONS

Prior to doing any adjusting work read the chapter "Adjusting the STEVENS Bicycle to the Rider" in your STEVENS operating instructions/manual or in your general bicycle manual. In these operating instructions we have compiled for you supplementary tips on a dropper post.

If you do not have the STEVENS operating instructions at hand, visit www.stevensbikes.de/manual

1. Adjusting the saddle height

Before you start adjusting the saddle height make sure the dropper post is completely raised by pressing the release lever.

To adjust the saddle height start by releasing the bolt at the seat post clamp of the bike frame by two to three turns until you are able to move the entire seat post. Bring the saddle to the desired height and align it with the frame by using the saddle nose and the bottom bracket or top tube as reference. Tighten the seat post clamp according to the marking on the clamp. If there is no marking, the maximum torque value is 6 Nm.

NOTE

If you are not able to pull the seat post further out of the frame, insert the dropper post cable housing at the head tube a little into the frame to produce a little more travel for the height adjustment.

WARNING

Observe the minimum insert depth marking "MINIMUM INSERT". At all times, the seat post must be inserted 100 mm at least into the frame. The marking must not become visible.

2. Adjusting the saddle position

To adjust the correct saddle position for you start by releasing both bolts no. 7 by two to max. three turns; otherwise the entire mechanism may fall apart.

Move the saddle forward or backward to adjust the horizontal position. You may have to give the saddle a light tap to move it. Observe the marking on the saddle rail and do not go beyond.

After you have found the desired position verify whether both clamp halves fit snugly around the saddle rail. Tighten both bolts evenly so that the saddle remains at the same angle. If you want to lower the nose of the saddle, tighten the front bolt clockwise. If necessary, you even have to loosen the rear bolt a little. To lower the rear part of the saddle, turn the rear bolt clockwise and loosen the front bolt, if necessary.

When everything is as you want it, increase the torque value to the indicated value of 8 – 10 Nm. After fastening the saddle, check whether it resists tilting by bringing your weight to bear on it once with your hands at either end of the saddle.

SAFETY INSTRUCTIONS

Make sure the top edge of the saddle is horizontal or, if necessary, a little lowered in the front. This is recommendable particularly in the case of full-suspension mountain bikes.

WARNING

The Oxygen Dropper Post is designed for saddles with round rails at a diameter of 7 mm and for highly ovalized rails at 7 x 9 mm. Using other saddles may result in a failure of the dropper post or the saddle. **Risk of a fall!**

3. Aligning the control lever

The control lever can be adjusted to your personal preferences. Loosen the bolt no. 8 at the control lever by two to three turns until the lever can easily be turned or shifted on the handlebar. Bring the lever into the desired position on the handlebar and tighten the bolt no. 8 to a torque value of max. 1.6 Nm.

WARNING

Over-tightening may result in the failure of a (carbon) handlebar. Risk of an accident!

4. Correcting the tension

A possible malfunction of the dropper post may be due to the fact that the cable is insufficiently tensioned. If you want to increase the tension, turn the adjuster no. 9 one to two turns anticlockwise in the plan view of the cable until it functions properly. Turning it to the right reduces the tension.

SAFETY INSTRUCTIONS

Contact your authorized STEVENS dealer, if the adjustment range is insufficient or in case of malfunctioning.

5. Cleaning

Clean your dropper post with a low-pressure water jet or a bucket of water and a sponge or a large brush. Cleaning it by hand has another positive side-effect: you may discover defects as well as damage at an early stage.

WARNING

During cleaning watch out for damage, such as bends, cracks, dents or discolourations, leakage of liquids, frayed cables/cable housings, loose or missing parts, deep scratches.

Have a damaged dropper post replaced immediately. If you are in doubt or if you have any questions, contact your authorized STEVENS dealer.

NOTE

Do not use solvents, spray oil or chemical spray cleaner for cleaning. Do not clean the seat post with a high-pressure cleaner.

Care and maintenance

What to do	Schedule	
Check bolt torque values	Before the first ride. Then according to maintenance schedule in your comprehensive STEVENS operating instructions/manual	User/owner
Lever and functional check	Before every ride	User/owner
Visual check (cracks, discolourations, bends)	Before every ride	User/owner
Cleaning	After every ride	User/owner
Full service (cartridge inspection/ telescope rebuild)	Every 100 hours of use/ annually	Authorized STEVENS dealer

Please coordinate all service and maintenance work through your authorized STEVENS dealer to ensure that your bicycle is properly maintained and cared for and that you safeguard the applicable warranties.

WARNING

Unauthorized service, maintenance and repair work can void the warranty and result in serious damage with a resulting risk of accident with unforeseeable consequences.

WARNING

Do not use the seat post when you

- detect damage, such as bends, cracks, dents or discolourations, leakage of liquids, frayed cables/cable housings, loose or missing parts, deep scratches or in case of malfunction of the seat post.
- were involved in an accident, crash or shock or when the seat post was exposed to any other unusual high load. If the seat post is damaged, it must be checked or replaced prior to any further use. Contact your authorized STEVENS dealer.

CONTACT

STEVENS Vertriebs GmbH

Asbrookdamm 35
D-22115 Hamburg
www.stevensbikes.de
info@stevensbikes.de