

輪組配備零件說明

套裝產品 A: 前輪、前輪快拆、插栓、插栓蓋。

套裝產品 B: 前輪、前輪快拆、後輪、後輪快拆、插栓、插栓蓋。

發電輪組安裝說明

1. 發電花鼓為快拆方式安裝。花鼓的連接器插座朝向車輪前進方向的右側。
2. 連接器插座調整為方便插頭插入的方向。
3. 快拆鎖入後，完成安裝。

若因連接器插頭不易插入或因需要理線而需要調整連接器插座方向時，請鬆開快拆後旋轉輪圈，切勿直接旋轉鎖附快拆後的連接器。

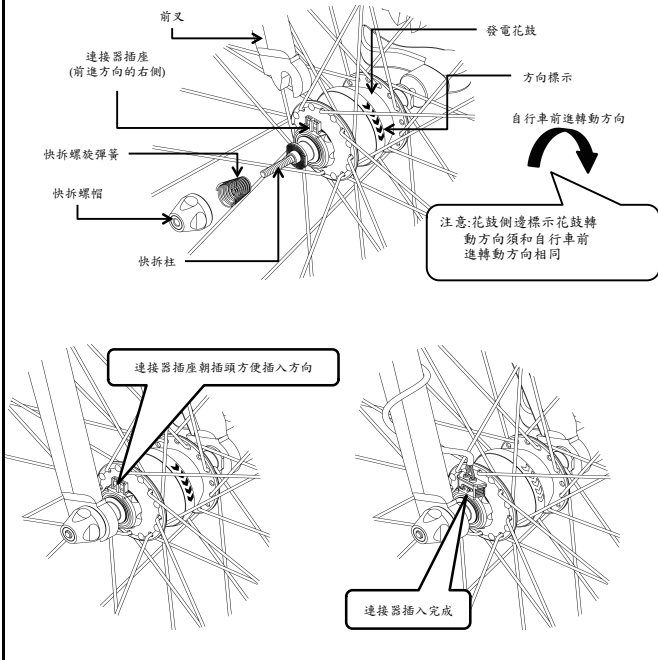

燈源電線和插頭安裝說明

1. 將燈源電線末端的兩條電線在適當長度去絕緣套，電線裸露長度約14mm。
2. 兩裸線分別穿入插栓上方兩孔，之後繞到插栓背部放線槽內。注意兩裸線不可接觸。
3. 套入插栓蓋固定，插栓的卡勾和插栓蓋的卡槽需確實卡入。
4. 電源插頭安裝完成。
5. 將插頭插入花鼓連接器插座並壓附到底(有卡入感)。
6. 燈源電線和插頭安裝完成。

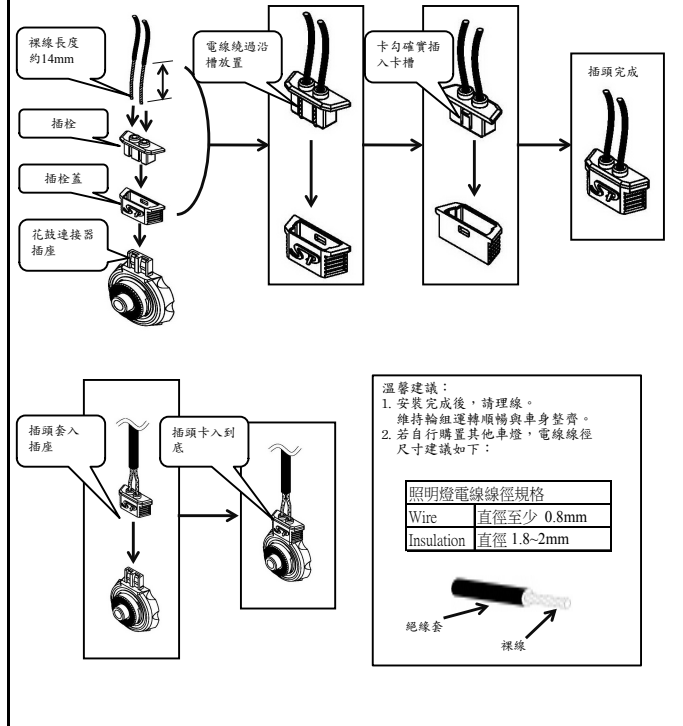

Product component list

Product set A: Front wheel, Front QR, Connector cap, Connector cover

Product set B: Front wheel, Front QR, Rear wheel, Rear QR, Connector cap, connector cover

Installation of the dynamo wheel

1. Dynamo wheel is for quick release type. The side with dynamo connection terminal is on the right when moving forward the bicycle.
2. Adjust connection terminal to face upward and therefore, it will be easier to plug in.
3. Screw quick release to the hub and finish dynamo wheel installation.

Note: If the connector cover is difficult to plug into connection terminal or want to tidy up the cable, it is not allowed to turn the connection terminal directly. It is necessary to loose quick release before turning the connection terminal. In addition, connector cover needs to remove from connection terminal.

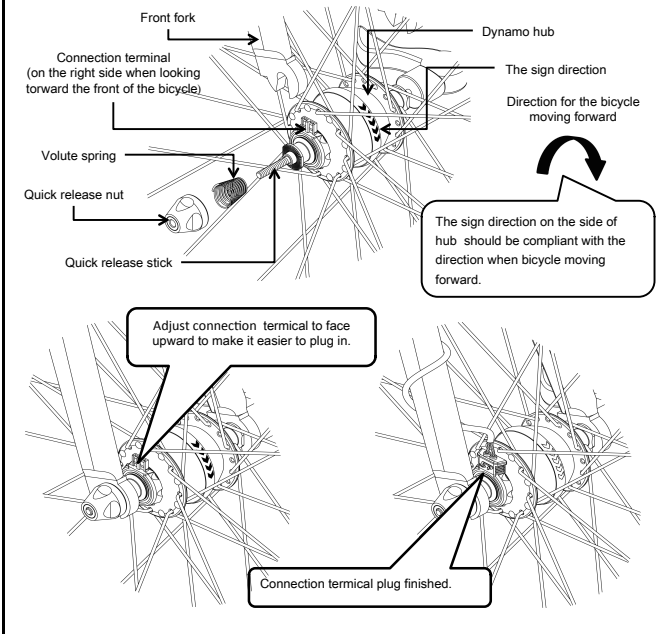

Connection of the cables

Step: 1. Get rid of the insulation on the end of two cables. The wire is 14mm approximately.

2. Two wires insert through two holes on the top of the connector cap respectively. Bend the wire and run them along the grooves. It is not allowed that two wires touch each other.
3. Insert the connector cap with wires into the connector cable perfectly.
4. Finish connection between wire and connector cover.
5. Put the connector cover into the connection terminal and press it to the bottom.
6. Finish the installation.

